

November 21, 2022

Mario Cucinella and Michel Desvigne create a bioclimatic urban regeneration to create a new district in Milan with landscape connections open to the city and dedicated to sports and leisure



Milan, Italy

Mario Cucinella and landscape architect Michel Desvigne's SeiMilano project for developer Borio Mangiarotti proposes the theme of the "garden city," pursuing an urban development model characterized by a newfound symbiosis between architecture and landscape.



The idea behind the SeiMilano intervention is to create an inhabited park open to the city dedicated to sport and leisure around which to distribute the various functions provided by the plan that are articulated on the two lines of strong urban value placed on the borders north and east of the area, leaving the green system of the park uncontaminated.

In particular, the axis that serves the area along the north-south route is configured as the true backbone of the new project, linking together a portion of the residences (48,000 square meters), the tertiary volumes (28,000 square meters) and the spaces commercial areas (8,000 square meters), while the boulevard along the northern end houses the remaining residential volumes (41,000 square meters) and plays a key role of connecting with the existing urban fabric.



The planivolumetric structure that Cucinella and Michel Desvigne have designed for the residential sector proposes a succession of n. 20 residential volumes with a square base positioned on different alignments and planes of rotation to ensure a non-homogeneous composition of the fronts and optimize the view and orientation on the new public park.

From an architectural point of view, the residential sector project proposes three different types of buildings:

The “loggia” type, is characterized by the presence of a grid frame within which loggias, window parts, and buffered elements are obtained;



The “terraced” typology is characterized by large balconies;

The “greenhouse/bow windows” type, characterized by regular windows alternating with glazed projections that act as real bioclimatic greenhouses and passive systems for capturing and exploiting solar energy.

The definition of this aesthetic language of residences comes from the desire to diversify the typologies to obtain a greater aesthetic and morphological variety, typical of urbanized contexts. The starting point is research on Milanese rationalist architecture, aimed at identifying its salient features, from which to move to define a new contemporary language, characterized by linear and essential elements.









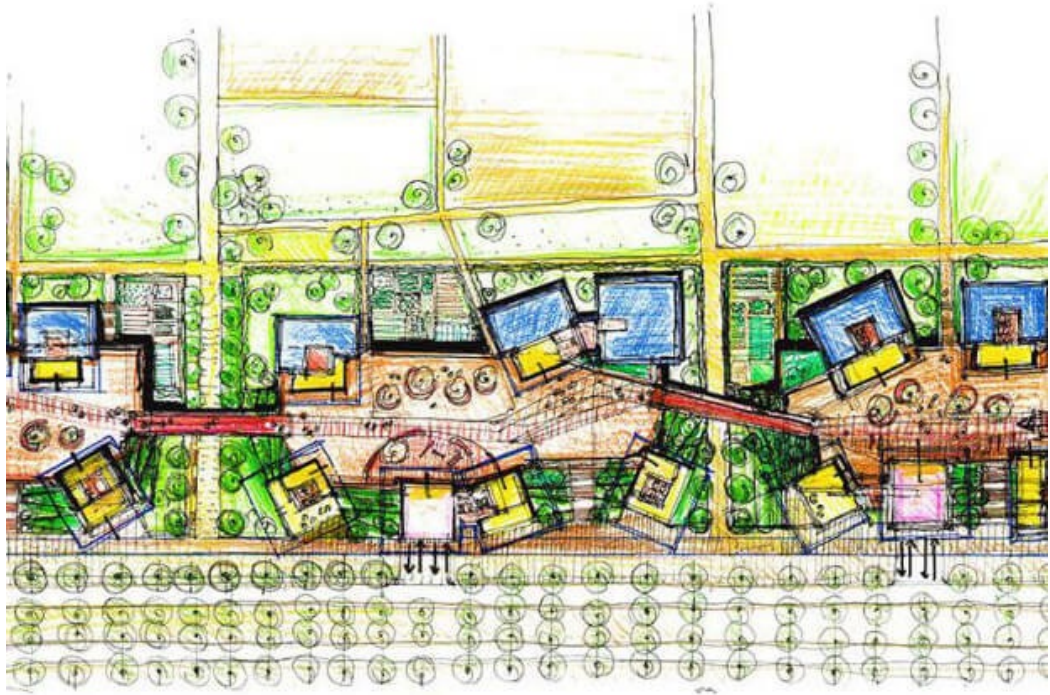



Project: SeiMilano

Architects: Mario Cucinella Architects

Lead Architect: Mario Cucinella

Design Team: Enrico Iascone, Michele Roveri, Maria Persichella, Fabrizio Bassetta, Alberto Menozzi, Cecilia Patrizi, Vaiva Rinkunaite, Edoardo Bernardi, Tommaso Boschi, and Sanaz Davardoust

Bioclimatic Designers: Andrea Rossi, Yuri Costantini, and Andrea Genovesi

Masterplanners: Michele Olivieri, Alberto Menozzi, Vaiva Rinkunaite, Stefano Bastia, Valentina Torrente, and Valentina Porceddu

Landscape Architects: MDP Michel Desvigne Paysagiste

Structural Engineers: Milan Ingegneria

Visuals: Alessia Monacelli and Francesco Cerulli

Client: Borio Mangiarotti SpA